

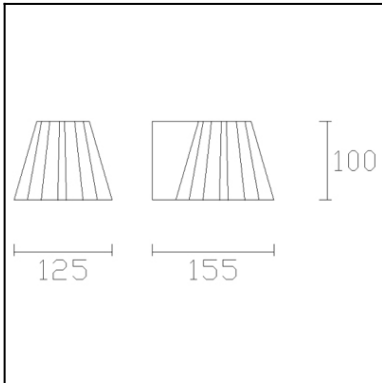

The photograph may not match the reference exactly. Please read the product description to identify the finish.

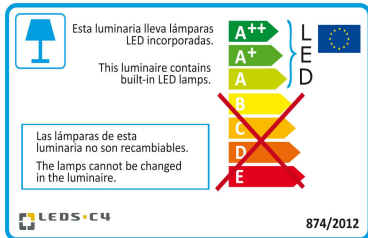

[Download photometric file .ldt / .ies](#)



[Click on image to download energy label](#)

TECHNICAL CHARACTERISTICS

Type:	Wall fixture
IP Protection degrees:	IP20
Light source 1:	1 x LED Bridgelux 6.2W Warm White - 2700K 550 lm ^(N) CRI 90
Total power consumption (W):	7.7
Voltage / Frequency:	100-240V/50-60Hz
Warranty (Years):	2
Option to extend the guarantee (Years):	5
Units per box:	12
Net Weight (Kg):	0.925



MATERIALS / FINISHES

Structure material:	Plaster	Diffuser material:	Steel shade Glass
Structure finish:	White	Diffuser finish:	Golden Sandblasted

GEAR

Multi-voltage electronic gear included (100-240V / 50-60Hz)

Lm^(N): Nominal flow of light in actual working conditions. Its actual flow will depend on the environmental conditions and the efficiency of the optics and/or diffuser.

LEDS-C4 reserves the right to make the necessary technical changes they deem adequate, in order to improve the features of the product.

Please consult the sales team to clarify any doubt.

(+34) 973 468 100
leds-c4@leds-c4.com
www.leds-c4.com

PLASTER/ WHITE

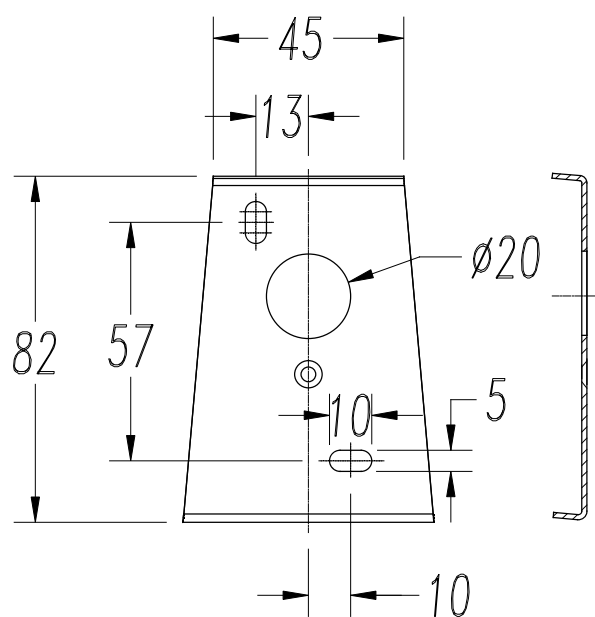
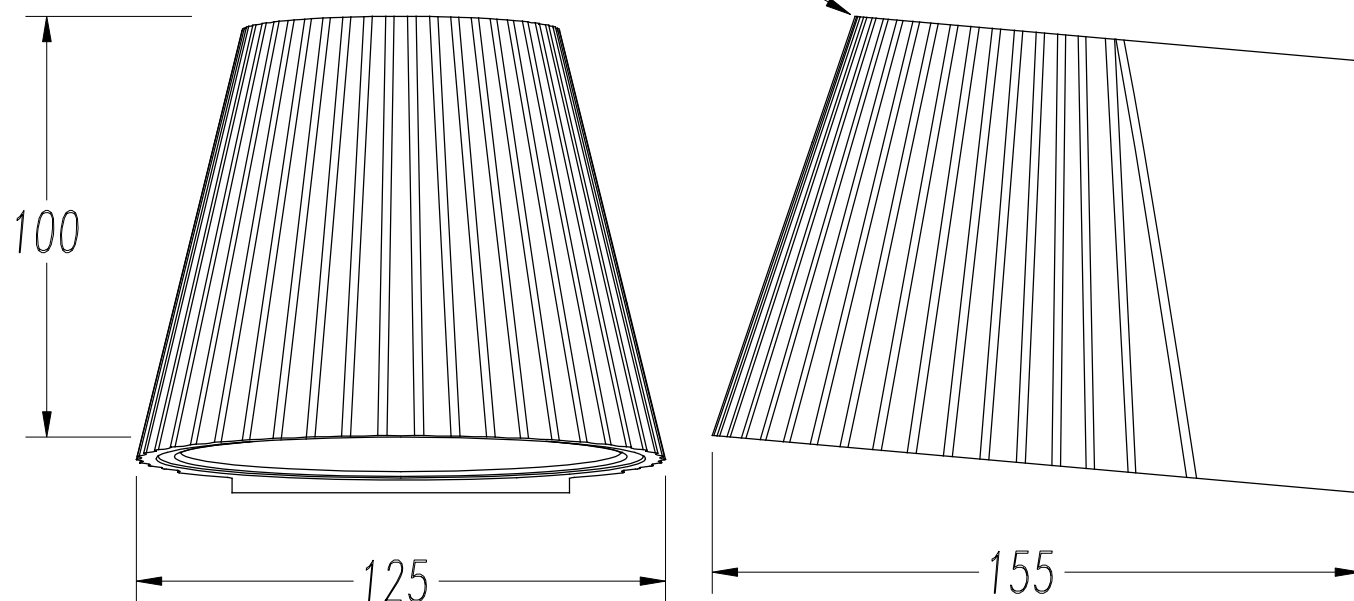

1

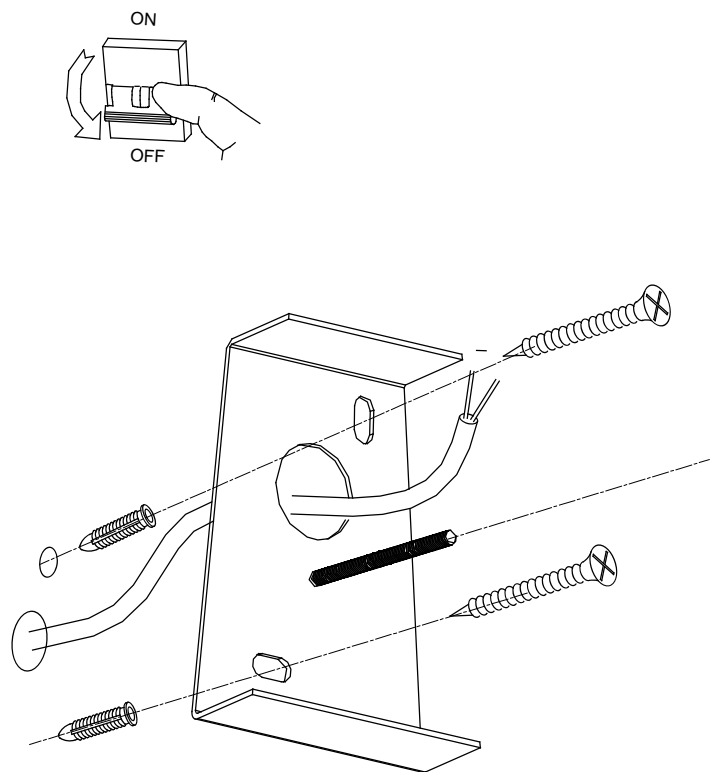

2

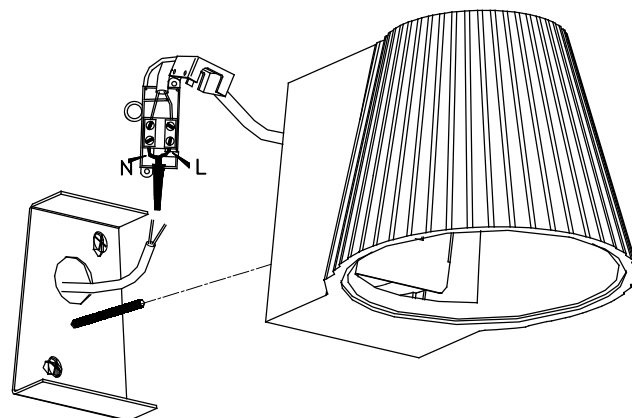

3

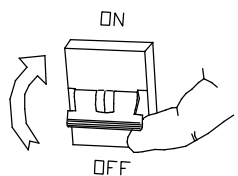
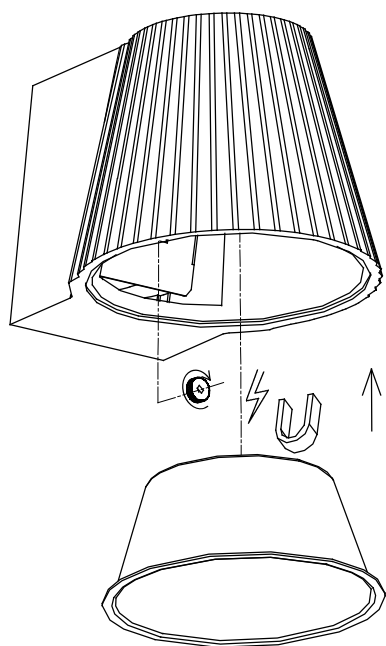

4

